

20' Satellite Lube Room

Instruction Manual

IMPORTANT

- Please read this Owners Manual carefully and thoroughly before installing and operating our Satellite Lube Room.
- Please retain this Owners Manual for future reference after reading it thoroughly.

TABLE OF CONTENTS

Explanation of Symbols Used	2
Warnings and Cautions	3
OilSafe Limited Warranty	4
General Notes & Requirements	5
Electrical Schematic	6
Electrical Installation, Fire Suppression & Drawings	7

FOR YOUR RECORDS

Write the model and serial numbers here: *(You can find them on the Serial/Model No. at the top right of the satellite Lube Room.)*

Serial / Model #: _____

Supplier Name: _____

Date Purchased: _____

READ THIS MANUAL

Inside you will find important information on how to use and maintain your OilSafe Satellite Lube Room.

INTELLECTUAL PROPERTY

OilSafe® is a Registered Trademark of Whitmore.

All Trademarks are the property of their respective owners.

All Rights Reserved.

Patents Pending.

© 2017 Whitmore

Explanation of Symbols Used

This manual contains some common symbols and indications to alert you to specific areas of importance.



WARNING!

A situation that, if not avoided, could result in severe property damage, equipment damage, severe injury, or even death. FAILURE TO FOLLOW this warning will void your product warranty.



CAUTION!

A situation that, if not avoided, could result in property damage, equipment damage, or injury. FAILURE TO FOLLOW this caution will void your product warranty.

IMPORTANT:

This text will be used before text that has been designated as important to the proper installation, operation, or maintenance of your system. FAILURE TO READ and understand this text may result in improper installation, operation, or maintenance procedures and may void your warranty.

TIP:

This text will be used to highlight text that is helpful in the installation, operation, and maintenance of your system.

NOTE:

This text will be used to highlight text that is important to read in order to fully understand the terms and procedures used in this manual.

Warning and Cautions

The OilSafe® Satellite Lube Room is designed for the storage of machinery lubricating oils and other NON-VOLATILE fluids. STORAGE OF FLUIDS WITH A FLASHPOINT BELOW 150°F (65.5°C) IS STRICTLY PROHIBITED.

Components within this system consist of materials that may not be compatible with your fluid. ALWAYS consult your supplier and refer to the fluid manufacturer's Material Safety Data Sheet ("MSDS") before introducing a fluid to this system.



WARNING!

ALWAYS ensure the main power supply is first locked out and the system depressurized before any service is performed on this system. NEVER connect or disconnect lines or change filter elements or undertake any service work when this system is running or energized. SEVERE INJURY OR DEATH MAY OCCUR.



CAUTION!

System Operating Pressure should NEVER exceed 300 PSI. Operating pressures can be regulated by adjusting pump bypass relief valves located on pump heads to suit specific lubricant viscosities and temperatures.

IMPORTANT:

ALWAYS REFER TO THIS MANUAL OR CONSULT YOUR SUPPLIER FOR MORE INFORMATION.

- ALWAYS ensure that you wear appropriate Personal Protective Equipment ("PPE") when operating this system.
- ALWAYS ensure that all system hoses, filters and fittings are securely fastened and in good working condition.
- THE OIL DRUM MUST ALWAYS BE VENTED TO ATMOSPHERE (preferably utilizing a Desiccant Air Breather).
- When dispensing or recirculating ALWAYS ensure the grounding cable is connected to the drum or barrel before starting the pump.
- ALWAYS ensure the system is appropriately grounded to earth utilizing relevant grounding equipment as specified and installed by your authorized electrical personnel in accordance with your local and federal regulations and safety procedures.
- Ambient room temperature where the system is installed should be in the range of 60°F (15°C) TO 80°F (26°C) with optimum room temperature being 70°F (21°C). For ambient temperatures below 60°F (15°C) consult the manufacturer or your supplier for the supply of electric blanket heaters for oil barrels, pails and bulk tanks to ensure stability of lubricant viscosity, condition and system performance. Temperatures less than (<60°F / 15°C) can result in lubricant viscosity increasing above the rated ISO Code you specified at the time of order. Such adverse viscosity changes can cause higher system operating pressures than those set at the factory. System operating pressure should never exceed 300 PSI as this can cause a gasket failure on the spin-on filter resulting in a high pressure oil leak. Normal system operating pressure should be less than 240 PSI. Operating pressures above 240 PSI will necessitate adjustment of the pump pressure relief bypass valve located on the pump head. Contact the manufacturer for more information prior to commissioning the system if the ambient room temperature will ever fall below 60°F (15°C).



WARNING!

FAILURE TO FOLLOW System installation, safety and operating instructions may result in SEVERE INJURY OR DEATH, damage to plant and equipment and void warranties.

OilSafe Limited Warranty

OilSafe ("OS") warrants to the original product purchaser (hereinafter the "Customer") that the OS product for which the Customer received this warranty was designed, developed and manufactured using all due reasonable commercial care and good manufacturing practices. OS' products shall be free from defects in material and workmanship for 182 days from the original date of purchase by Customer. OS' sole obligation under this warranty is to repair or replace the product, at OS' option. OS must be notified by Customer in writing of any claim under this warranty within 30-days of any claimed lack of conformity of the product. THIS WARRANTY IS INTENDED TO BE IN LIEU OF ALL OTHER WARRANTIES, WHETHER EXPRESS OR IMPLIED. OS SPECIFICALLY DISCLAIMS THE IMPLIED WARRANTIES OF MERCHANTABILITY AND FITNESS FOR A PARTICULAR PURPOSE.

Warranty Limitations:

In no event shall OS be liable for any loss, inconvenience or damage, whether direct, incidental, consequential or otherwise, resulting from breach of any express or implied warranty or condition, of merchantability, fitness for a particular purpose or otherwise with respect to this product, except as set forth herein. Some states or countries do not allow limitation on how long an implied warranty lasts so the above limitations or exclusions may not apply to you. This warranty gives you specific legal rights, and you may also have other rights, which may vary, from location to location. This warranty will be interpreted pursuant to the laws of the United States and the State of Illinois. The original English language version (meaning) of this warranty controls over all translations; OS is not responsible for any errors in translation of this warranty and/or any product instructions. This warranty is not intended to confer any additional legal, jurisdictional or warranty rights to you other than those set forth herein or required by law. If any portion of this warranty is held to be invalid or unenforceable for any reason, such finding will not invalidate any other provision. For products purchased in countries other than the United States, please contact OS' authorized representative (i.e., the 'company' or 'person' who represented OS or brokered the 'sale') in the country where the product was purchased.

Warranty Service Options:

For service under this warranty you must notify OS in writing. Such notification must specify in writing the product in question by model and serial number, applicable purchase order number and/or the original of date of your written notification.

You may contact OS as follows:



**930 Whitmore Drive
Rockwall, TX 75087 USA**

Telephone: (972) 771-1000

Fax: (972) 722-3252

**Email: sales@oilsafe.com
www.oilsafe.com**

Any insurance and/or shipping costs incurred in returning your OS product for service pursuant hereto are your responsibility. OS will not be responsible for any products lost or damaged in shipment.

Warranty Exclusions:

Representatives and brokers of OS products are not authorized to modify this warranty in any way. It is the Customer's responsibility to regularly examine the product to determine the need for normal service or replacement. This warranty does not cover the following:

- Products that have been modified, neglected or poorly maintained, misused, abused or involved in accidents or natural disasters.
- Damage occurring during shipment of the product (such claims must be presented directly to the freight forwarder or shipping company).
- Damage to the product resulting from improper maintenance or repair, the use or installation of parts and/or accessories that are not compatible with the original intended use of the product, or the failure to follow the product warnings and usage instructions.
- Damage or deterioration to the surface finish, aesthetics or appearance of the product.
- The labor costs required to remove and/or refit and readjust the product covered by this warranty.
- Normal wear and tear to the product.
- Filter Cartridges, Desiccant Air Breathers, Level Gauges and other consumable items.
- Service Trips to Customer's location to teach Customer how to use the product.
- Defects that result from improper installation or damage not cause by OS.
- Damage to the product caused by accident, fire, floods or other acts of God.

General Notes:

This Satellite Lube Room is classified as a temporary movable structure. It is the end user's responsibility to comply with local license and code requirements. Installation and Electrical work is to be performed by licensed contractors. The unit should not be structurally modified or stacked with other shipping containers unless given written preapproval by OilSafe.

Transport Requirements:

Prior to shipping, end user should ensure all equipment is properly anchored and that all fasteners are tightened. The Satellite Lube Room must be completely empty of all fluids including any oils or lubricants in the storage tanks. The fire suppression system must be deactivated by an OilSafe approved technician. Prior to shipping, check that floor treads have clips and that the emergency access hatch is securely fastened.

Site Requirements:

To ensure safety and performance, the four corners of the unit must be supported by a flat and level reinforced concrete spread footings or by a concrete slab.

- o Refer to attached dimensional drawings.
- o Exterior Electrical panel should have a minimum 36" clearance for access.
- o Footings should be elevated as required to prevent steel from directly contacting soil.
- o Slabs should be sloped to provide adequate drainage away from the unit and to prevent pooling of water.

FOOTING MINIMUM DESIGN LOAD

- Foundations should be designed to support an allowable point load of 2,500 lbs at each corner.

Electrical System:

The Satellite Lube Room is equipped to receive power from a 4 conductor single phase 240VAC supply circuit (200A max). All plugs and equipment onboard use 120VAC except for the air conditioning unit which is powered by 240VAC. Each pump on the OilSafe system has an individual breaker at the sub panel in addition to local overload protection.

- 1) 200A Fused S.E. Exterior Enclosure with Service Disconnect, 3R NEMA Enclosure Type, 200A AC rated for 25 HP @ 240VAC HP
- (1) Sub Panel, 120/240 VAC equipped with (12) 110 VAC Breakers and (1) 220 VAC breaker
- (1) 200A Main breaker
- (1) Emergency Shut Off Switch, 3R NEMA Enclosure Type, 200A AC rated for 25 HP @ 240VAC HP
- (2) Fuses, 200A, Class H, NON, 250VAC 120/240 VAC
- (1) 15amp Quad receptacle, (8) Individually breakered 20 amp 110 VAC receptacles
- (1) Extension cord equipped with (3) 15A outlets
- (1) Metal Louvered Exhaust Fan
- (1) 12,000 BTU Window A/C and Heating Unit 240 VAC
- (1) Battery Powered Emergency Exit Sign
- (1) Battery Powered Automatic Emergency Light
- (1) Exterior LED Dusk to dawn light

Electrical Installation:

A Licensed Electrician is required to connect the unit to a supply circuit. The unit should be treated as a remote building and requires proper equipment grounding as required per local code requirements. The unit is un-bonded and should not serve as a service entrance.

Fire Suppression:

The unit is equipped with an automatic fire suppression system designed to contain flames with the container doors both closed and open. The exterior of the unit has a manual pull switch to activate the fire suppression system. Once the unit is activated an alarm will ring inside. The fire suppression system was installed by certified licensed contractors and installation was manufacturer approved by Firetrol. It is the End User's responsibility to comply with local fire permitting and code requirements. See attached drawings and manufacturer cut-sheets for additional details not listed here.

- Initial activation of Fire Suppression system is required by Whitmore technician or an OilSafe approved local fire suppression technician prior to operation. See "Monarch Fire Suppression Operating Instructions" for details.
- The fire suppression system is a dry chemical type and is non oxygen depleting.
- The system must be inspected and recharged or repaired by licensed fire suppression technicians after activation.
- Upon activation the fire suppression system is designed to trigger relays that will de-energize the exhaust fan and AC/Heater unit

Satellite Lube Room Drawings:

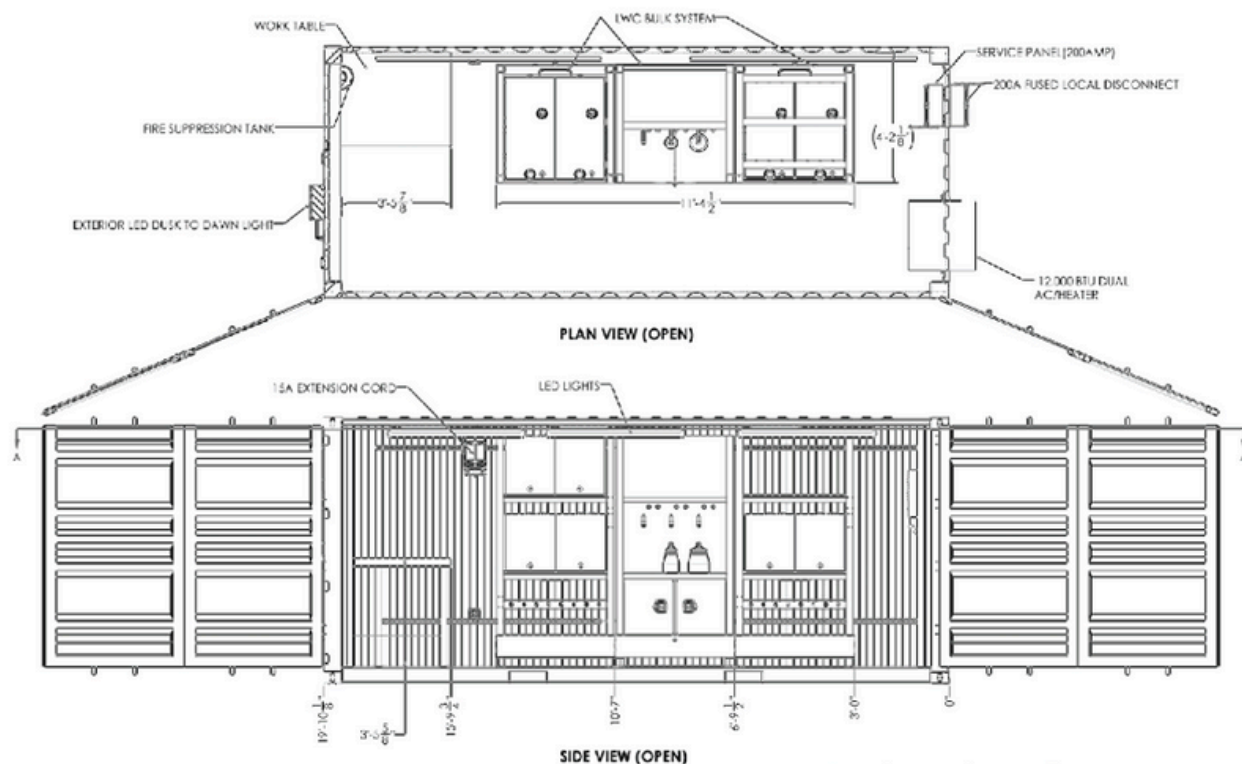

Satellite Lube Room

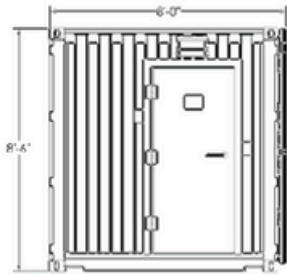

LEFT SIDE VIEW

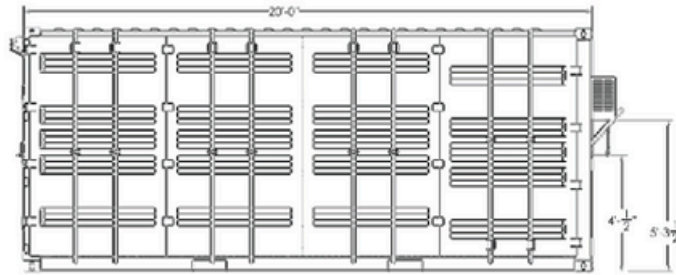

SIDE VIEW (CLOSED)

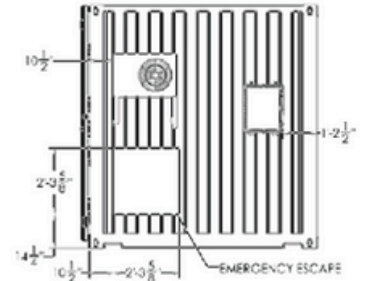

RIGHT SIDE VIEW

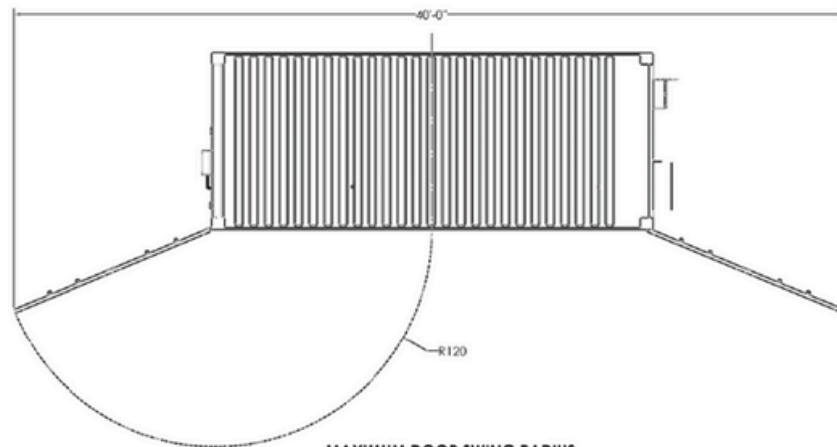

MAXIMUM DOOR SWING RADIUS

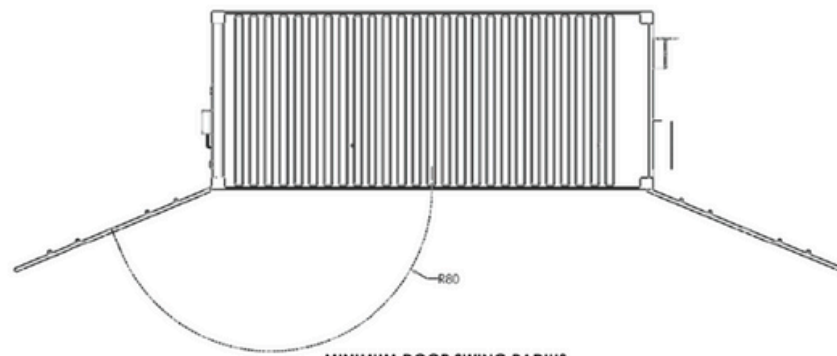

MINIMUM DOOR SWING RADIUS