

Series 100 Simplex Housing

TTI's PowerGuard™ housing line is manufactured in Germany with premium German components and assembled in the USA. All TTI Housings are available standard with a bypass valve, visual indicator, SAE connections and produced to be highly serviceable. The TTI housing line provides the versatility for intermittent or continual flow operations, while offering a range of flow and pressure ratings compatible with inline pressurized systems and return line filtration.



Simplex Aluminum
PowerGuard Housing

SPECIFICATIONS

- Nominal working pressure - 900 PSI
- Visual indicator for element change out standard - 32 PSI
- Automatic bypass valve standard - 50 PSI Bypass Valve
- Operating temperature: -22°F to 248°F

Flow Characteristics

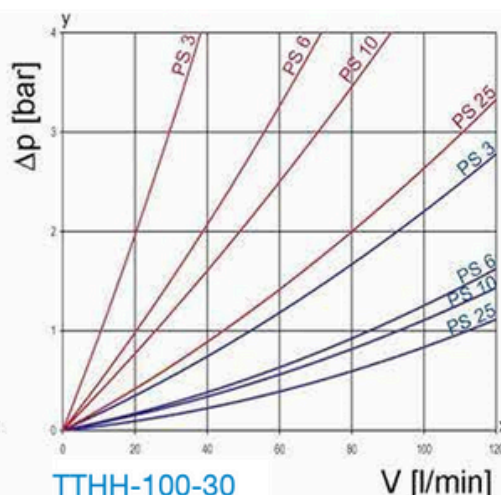
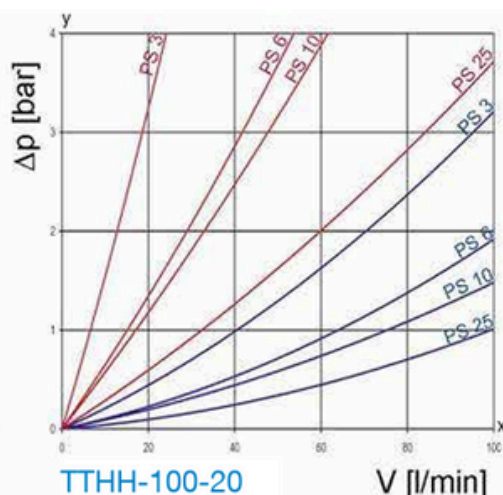
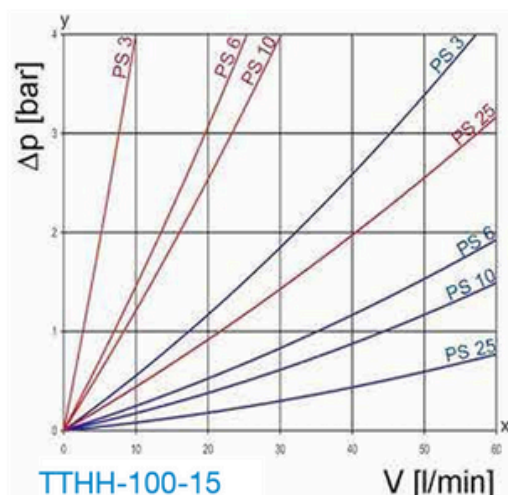

Fluid Viscosity

190 mm²/s 33 mm²/s

Series 100 Simplex Housing

Top Applications

- Hydraulic systems – hydraulic oil
- Gas turbines – turbine oil
- Gearbox lube systems – gear oil
- Machine Coolant

Top Industries

- Power Generation
- Steel Mills
- Pulp & Paper
- Mining

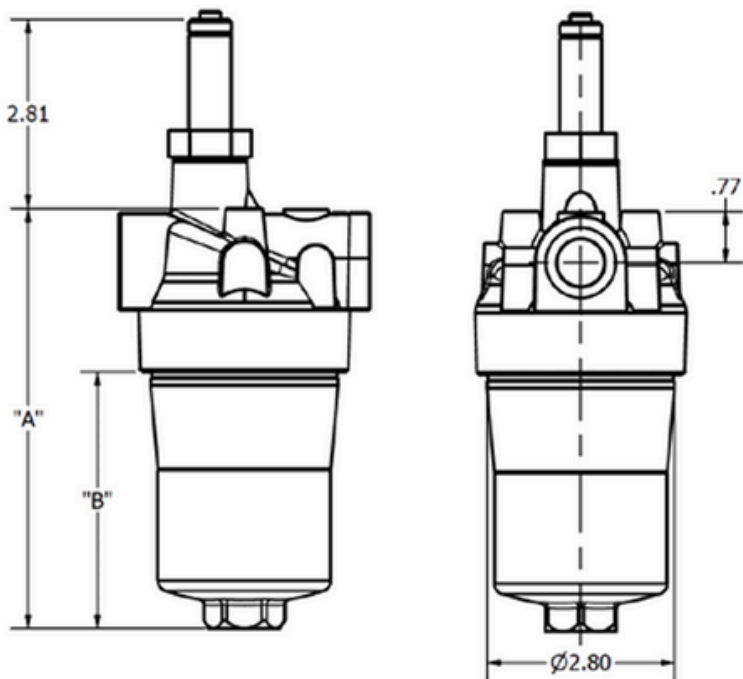
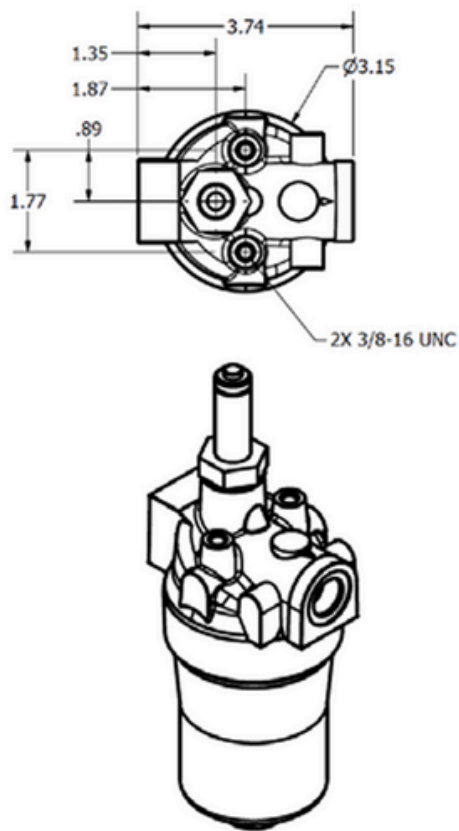

Dimensions in Inches

PART NUMBER*	"A" Height	"B" Bowl Length	INLET OUTLET
TTHH-100-15-VBB	6.5	4.1	SAE-12
TTHH-100-20-VBB	8.8	6.4	SAE-12
TTHH-100-30-VBB	12.4	10	SAE-12

3 Material Ordering Options:
V/E/X : Visual / Electrical / None
B / X: Bypass / None
B / V: Buna / Viton

For example:
TTHH-100-15-VBB: Series 100 Housing, 15gpm nominal flow rate, Visual Indicator, Bypass Valve, Buna-N Seals

Series 110 Simplex Housing

TTI's PowerGuard™ housing line is manufactured in Germany with premium German components and assembled in the USA. All TTI Housings are available standard with a bypass valve, visual indicator, SAE connections and produced to be highly serviceable. The TTI housing line provides the versatility for intermittent or continual flow operations, while offering a range of flow and pressure ratings compatible with inline pressurized systems and return line filtration.



Simplex Aluminum
PowerGuard Housing

SPECIFICATIONS

- Nominal working pressure - 450 PSI
- Visual indicator for element change out standard - 32 PSI
- Automatic bypass valve standard - 50 PSI Bypass Valve
- Operating temperature: -22°F to 248°F

Flow Characteristics

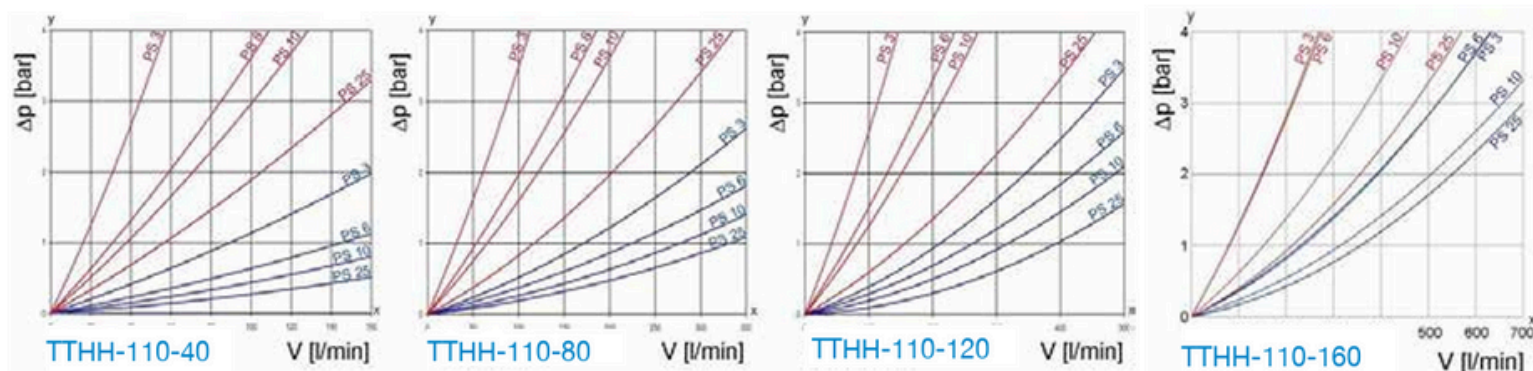

Fluid Viscosity

190 mm²/s 33 mm²/s

Series 110 Simplex Housing

Top Applications

- Hydraulic systems – hydraulic oil
- Gas turbines – turbine oil
- Gearbox lube systems – gear oil
- Machine Coolant

Top Industries

- Power Generation
- Steel Mills
- Pulp & Paper
- Mining

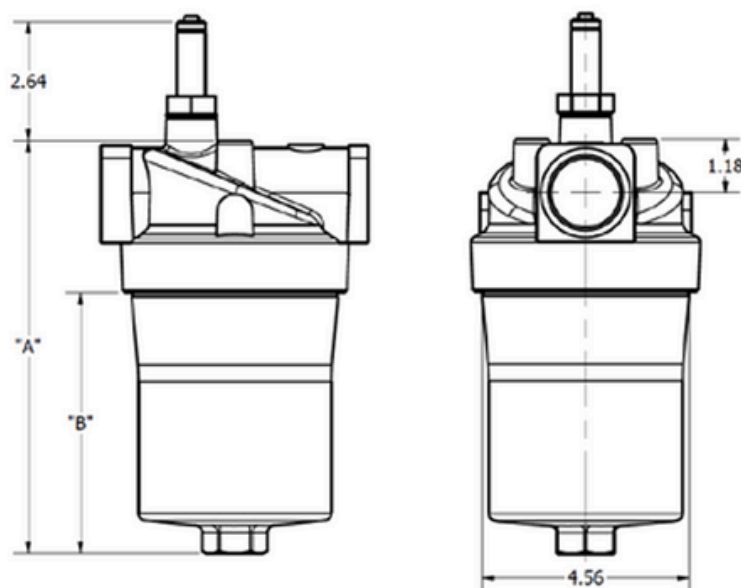
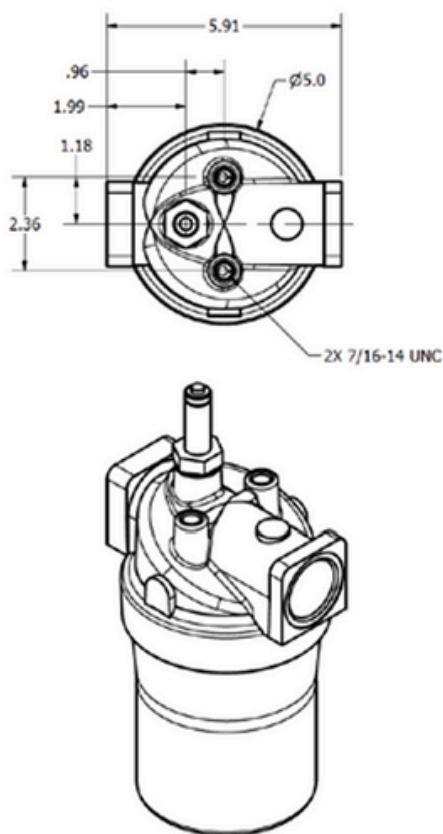

Dimensions in Inches

PART NUMBER*	"A" Height	"B" Bowl Length	INLET OUTLET
TTHH-110-40-VBB	9.1	5.7	SAE-20
TTHH-110-80-VBB	13.6	10.5	SAE-20
TTHH-110-120-VBB	18.2	14.9	SAE-20
TTHH-110-160-VBB	23.7	20.3	SAE-20

3 Material Ordering Options:
V/E/X : Visual / Electrical / None
B / X: Bypass / None
B / V: Buna / Viton

For example:
TTHH-110-40-VBB: Series 110 Housing, 40gpm nominal flow rate, Visual Indicator, Bypass Valve, Buna-N Seals

Hubame

Distribuidor autorizado

www.hubame.com.mx | marketing@hubame.com.mx | Teléfono (81) 8000 7600

Series 120 Simplex Housing

TTI's PowerGuard™ housing line is manufactured in Germany with premium German components and assembled in the USA. All TTI Housings are available standard with a bypass valve, visual indicator, SAE connections and produced to be highly serviceable. The TTI housing line provides the versatility for intermittent or continual flow operations, while offering a range of flow and pressure ratings compatible with inline pressurized systems and return line filtration.



Simplex Steel
PowerGuard Housing

SPECIFICATIONS

- Nominal working pressure - 4500 PSI
- Visual indicator for element change out standard - 72 PSI
- Automatic bypass valve standard - 101 PSI Bypass Valve
- Operating temperature: -22°F to 248°F

Flow Characteristics

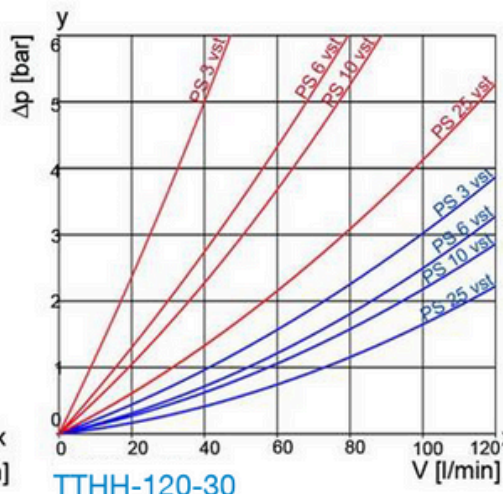
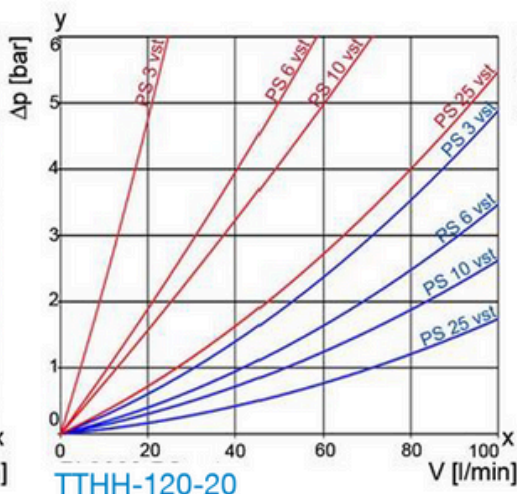
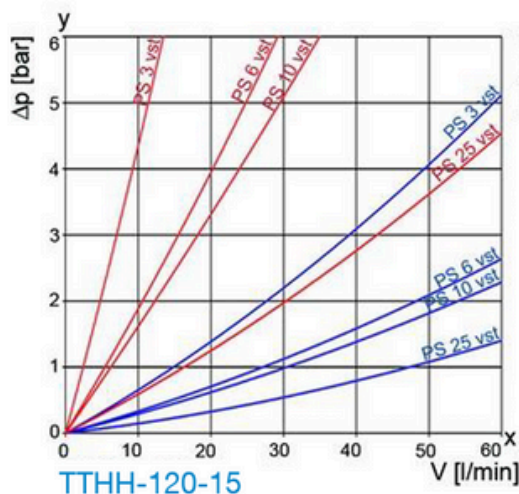

Fluid Viscosity

190 mm²/s 33 mm²/s

Series 120 Simplex Housing

Top Applications

- Hydraulic systems – hydraulic oil
- Gas turbines – turbine oil
- Gearbox lube systems – gear oil
- Machine Coolant

Top Industries

- Power Generation
- Steel Mills
- Pulp & Paper
- Mining

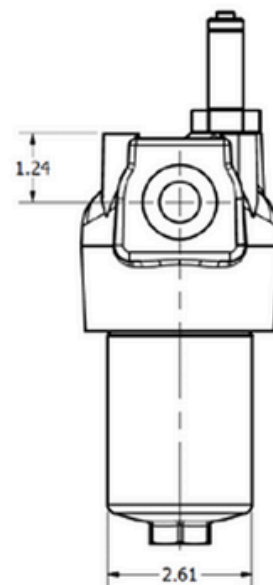
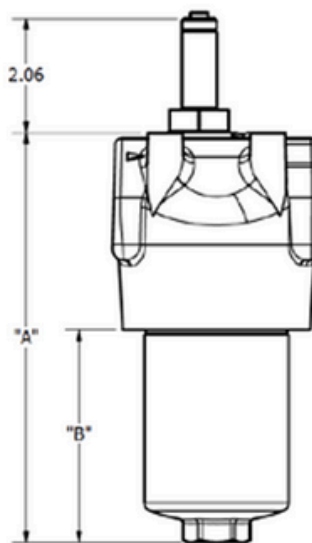
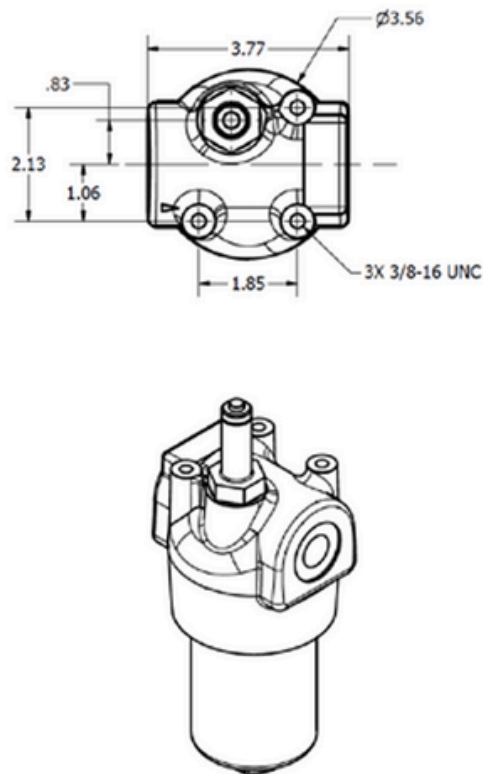

Dimensions in Inches

PART NUMBER*	"A" Height	"B" Bowl Length	INLET OUTLET
TTHH-120-15-VBB	7.4	3.9	SAE-12
TTHH-120-20-VBB	10.5	6.9	SAE-12
TTHH-120-30-VBB	13.5	9.9	SAE-12

3 Material Ordering Options:
V/E/X : Visual / Electrical / None
B / X: Bypass / None
B / V: Buna / Viton

For example:
TTHH-120-15-VBB: Series 120 Housing, 15gpm nominal flow rate, Visual Indicator, Bypass Valve, Buna-N Seals

Hubame

Distribuidor autorizado

www.hubame.com.mx | marketing@hubame.com.mx | Teléfono (81) 8000 7600

Series 130 Simplex Housing

TTI's PowerGuard™ housing line is manufactured in Germany with premium German components and assembled in the USA. All TTI Housings are available standard with a bypass valve, visual indicator, SAE connections and produced to be highly serviceable. The TTI housing line provides the versatility for intermittent or continual flow operations, while offering a range of flow and pressure ratings compatible with inline pressurized systems and return line filtration.



Simplex Steel
PowerGuard Housing

Specifications

- Nominal working pressure - 3000 PSI
- Visual indicator for element change out standard - 72 PSI
- Automatic bypass valve standard - 101 PSI Bypass Valve
- Operating temperature: -22°F to 248°F

Flow Characteristics

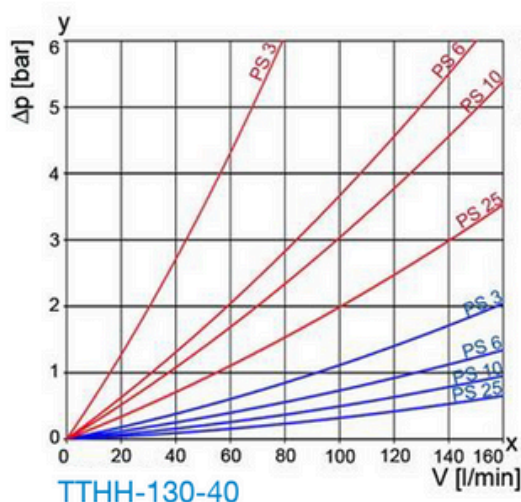

TT1833 Series

TTI's PowerGuard™ filter line leverages our proprietary DuoGlass media and world-class product design to ensure unparalleled filtration performance.

Manufactured in the USA and Germany, our Dual Phase Microglass technology provides Beta 1000 efficiencies with a built-in pre-filter layer to reduce initial pressure drops and extend the life of your filter elements.

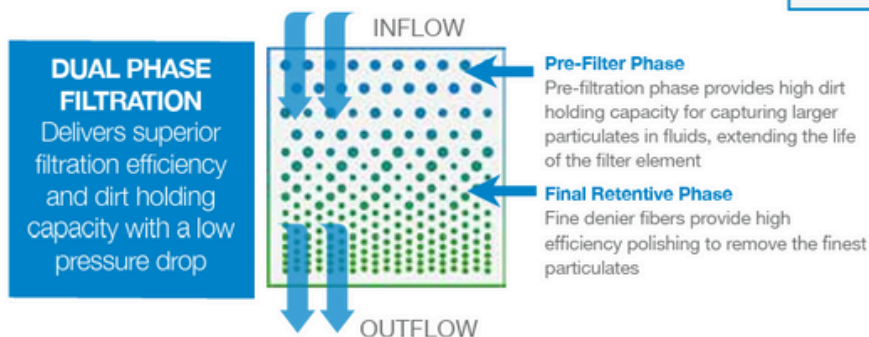

PERFORMANCE

- 290 PSID collapse pressure
- 50 PSID change out recommended
- 250°F (121°C) maximum operating temperature

Dimensions

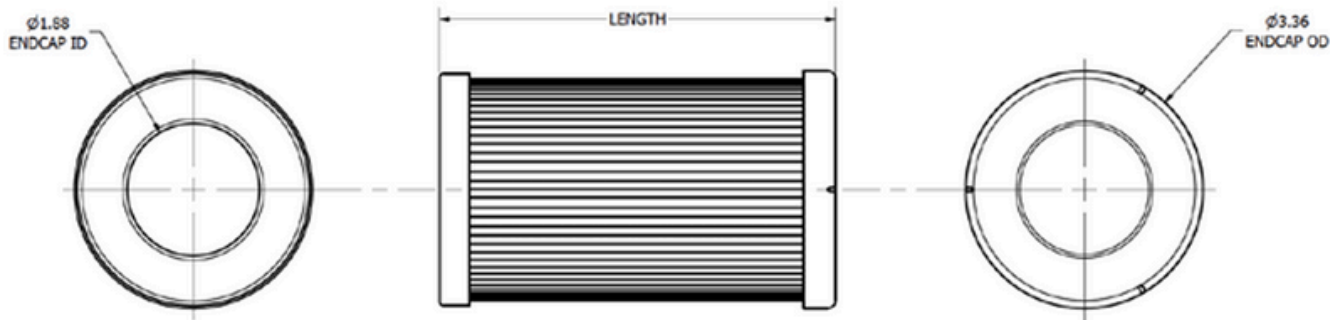

Part Number Builder

TTI PN	-	Length (inches)	-	Micron Rating (µm)	Media Type
TT1833		40 = 5.60		1	40*
		80 = 10.10		3	74*
		120 = 14.68		6	149*
		160 = 20.10		10	
				25	

(Omit) = Dual Phase Microglass
Standard option β1000, available in 1, 3, 6, 10, 25µm

WA = Water Absorptive
Available in 3, 6, 10, 25µm

SD = Static Dissipative
Viton seals only, available in 1, 3, 6, 10, 25µm

*W = Stainless Steel Wire Mesh
Only available in nominally rated 25, 40, 74, 149µm
40µm available in - 80 length only

Series 200 Duplex Housing

TTI's PowerGuard™ housing line is manufactured in Germany with premium German components and assembled in the USA. All TTI Housings are available standard with a bypass valve, visual indicator, SAE connections and produced to be highly serviceable. The TTI housing line provides the versatility for intermittent or continual flow operations, while offering a range of flow and pressure ratings compatible with inline pressurized systems and return line filtration.



Specifications

- Nominal working pressure - 900 PSI
- Visual indicator for element change out standard - 32 PSI
- Automatic bypass valve standard - 50 PSI Bypass Valve
- Operating temperature: -22°F to 248°F

Flow Characteristics

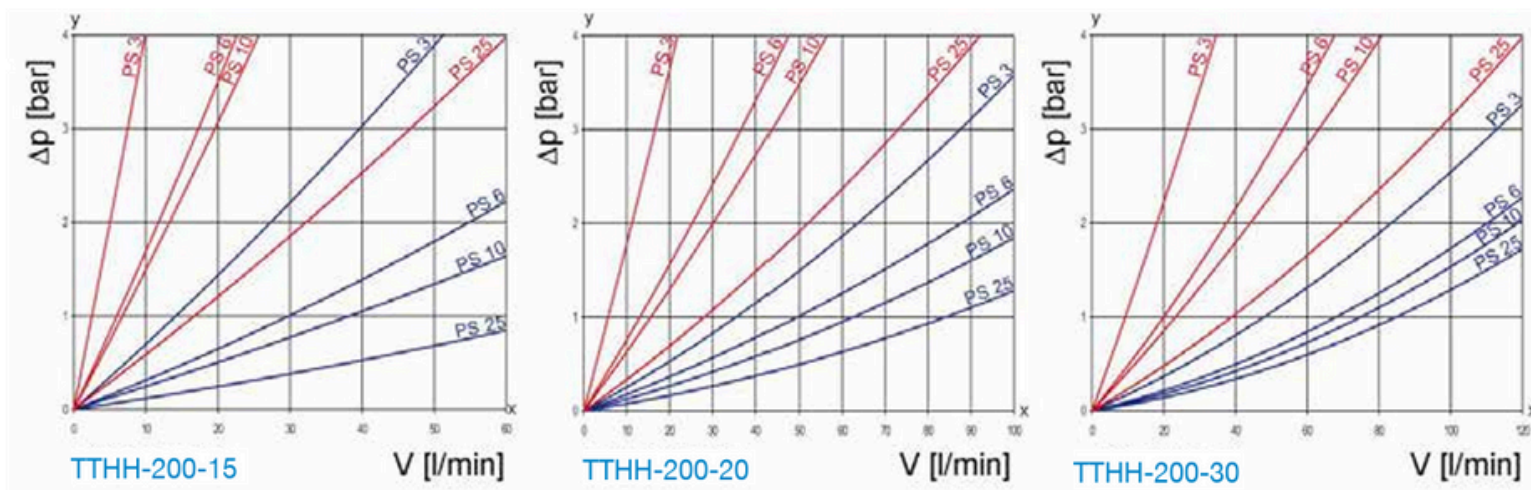

Fluid Viscosity

190 mm²/s 33 mm²/s

Series 210 Duplex Housing

TTI's PowerGuard™ housing line is manufactured in Germany with premium German components and assembled in the USA. All TTI Housings are available standard with a bypass valve, visual indicator, SAE connections and produced to be highly serviceable. The TTI housing line provides the versatility for intermittent or continual flow operations, while offering a range of flow and pressure ratings compatible with inline pressurized systems and return line filtration.



Specifications

- Nominal working pressure - 450 PSI
- Visual indicator for element change out standard - 32 PSI
- Automatic bypass valve standard - 50 PSI Bypass Valve
- Operating temperature: -22°F to 248°F

Flow Characteristics

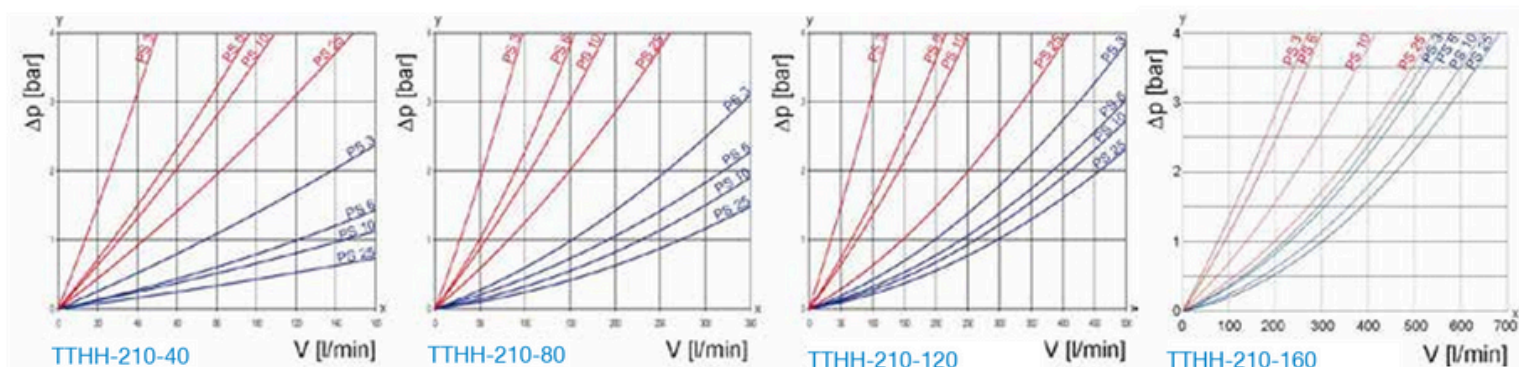

Fluid Viscosity

190 mm²/s 33 mm²/s

Series 230 Duplex Housing

TTI's PowerGuard™ housing line is manufactured in Germany with premium German components and assembled in the USA. All TTI Housings are available standard with a bypass valve, visual indicator, SAE connections and produced to be highly serviceable. The TTI housing line provides the versatility for intermittent or continual flow operations, while offering a range of flow and pressure ratings compatible with inline pressurized systems and return line filtration.



Specifications

- Nominal working pressure - 3000 PSI
- Visual indicator for element change out standard - 72 PSI
- Automatic bypass valve standard - 101 PSI Bypass Valve
- Operating temperature: -22°F to 248°F

Flow Characteristics

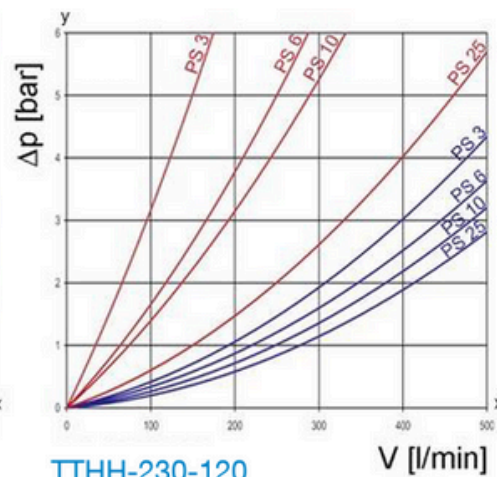
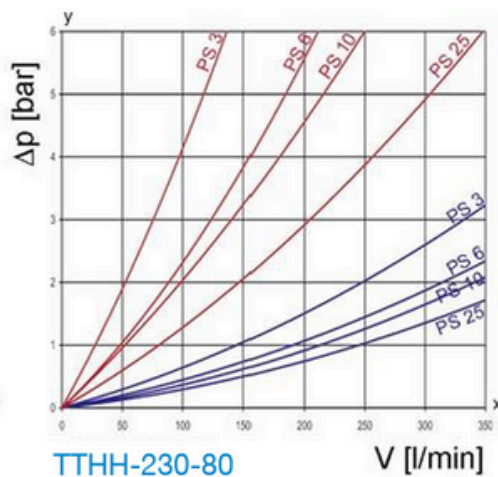
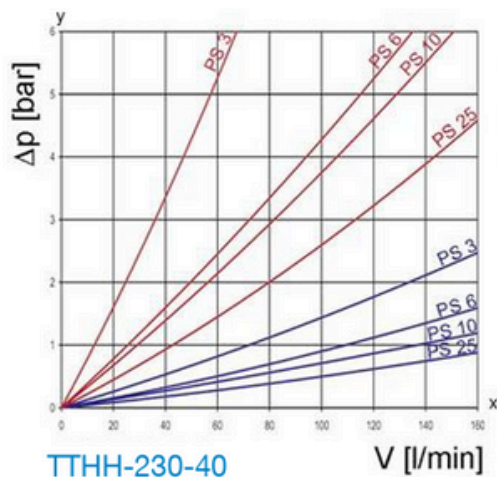

Fluid Viscosity

190 mm²/s 33 mm²/s

TT1833 Series

TTI's PowerGuard™ filter line leverages our proprietary DuoGlass media and world-class product design to ensure unparalleled filtration performance.

Manufactured in the USA and Germany, our Dual Phase Microglass technology provides Beta 1000 efficiencies with a built-in pre-filter layer to reduce initial pressure drops and extend the life of your filter elements.

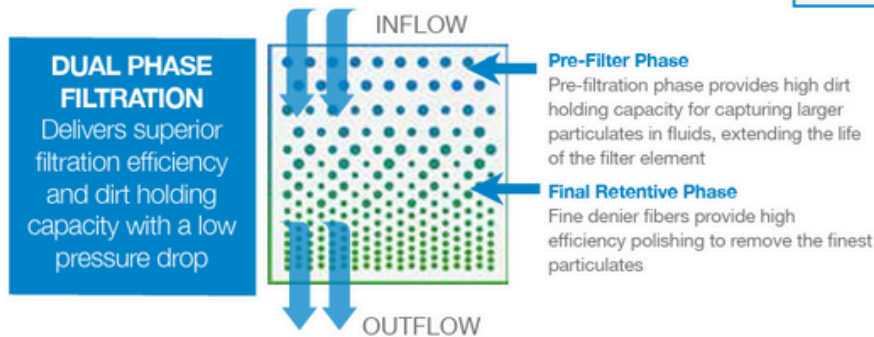

PERFORMANCE

- 290 PSID collapse pressure
- 50 PSID change out recommended
- 250°F (121°C) maximum operating temperature

Dimensions

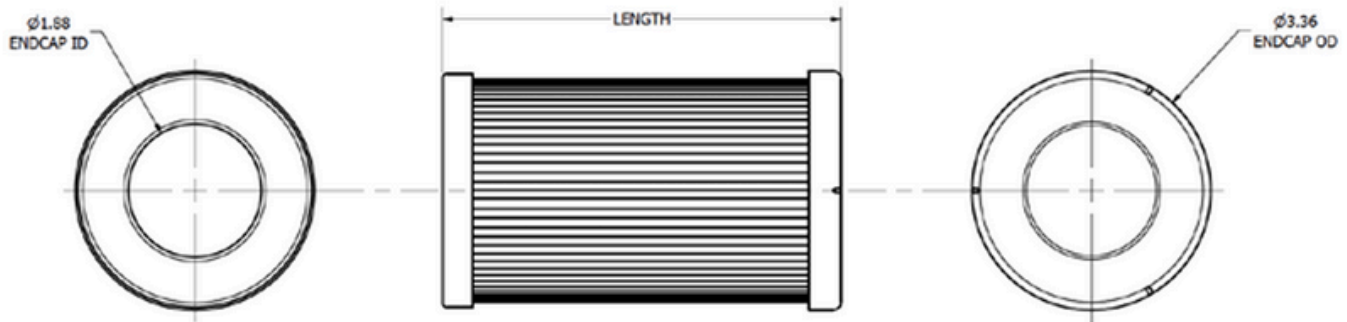

Part Number Builder

TTI PN	-	Length (inches)	-	Micron Rating (µm)	Media Type
TT1833		40 = 5.60		1	40*
		80 = 10.10		3	74*
		120 = 14.68		6	149*
		160 = 20.10		10	
				25	

(Omit) = Dual Phase Microglass
Standard option β1000, available in 1, 3, 6, 10, 25µm

WA = Water Absorptive
Available in 3, 6, 10, 25µm

SD = Static Dissipative
Viton seals only, available in 1, 3, 6, 10, 25µm

*W = Stainless Steel Wire Mesh
Only available in nominally rated 25, 40, 74, 149µm
40µm available in - 80 length only

TT1018 Series

TTI's PowerGuard™ filter line leverages our proprietary DuoGlass media and world-class product design to ensure unparalleled filtration performance.

Manufactured in the USA and Germany, our Dual Phase Microglass technology provides Beta 1000 efficiencies with a built-in pre-filter layer to reduce initial pressure drops and extend the life of your filter elements.

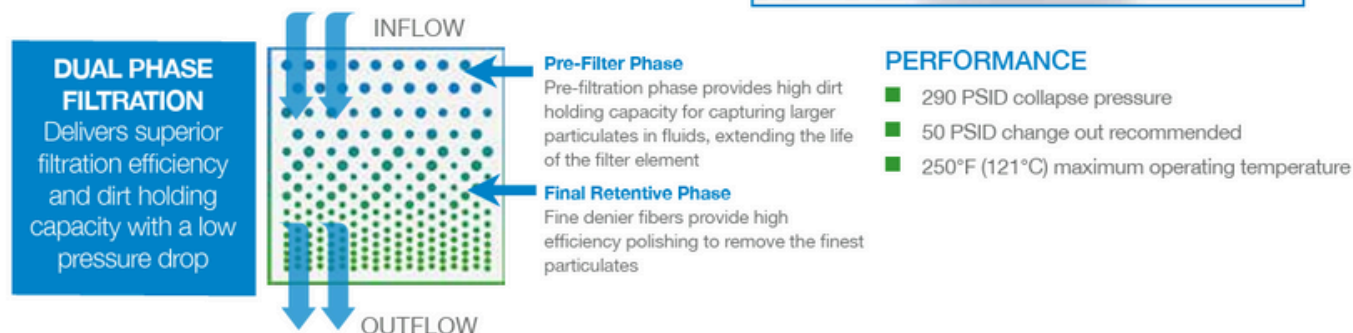

Dimensions

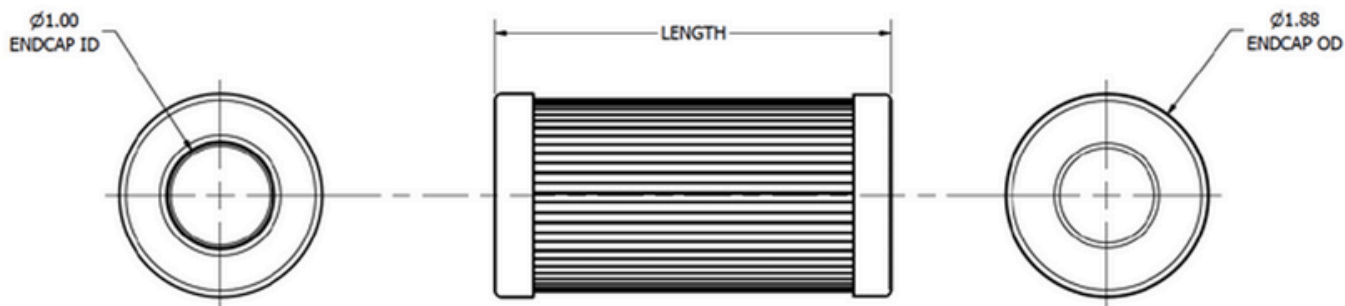

Part Number Builder

TTI PN	-	Length (inches)	-	Micron Rating (µm)	Media Type
TT1018		15 = 3.68		1	74*
		20 = 6.73		3	149*
		30 = 9.73		6	
				10	
				25	

TTHH-626 Housing

TTI's PowerGuard™ high capacity housing line offers a standard 304 Stainless Steel construction that is available in both an 18" and 36" lengths. With features such as a hinge block located on the lid, and 2 ports on both the inlet and outlet of the housing to accommodate differential and sampling gauges.

Specifications

- 150 PSI working pressure
- 304 Stainless Steel
- Hinged lid for safe, ergonomic filter changeouts



Connection Types

2" FNPT



2" Flange



3" Flange



TT626 Series

TTI's PowerGuard™ Filter line is produced in the USA using USA and German materials. TTI has leveraged 58 years of filter manufacturing expertise of FG Industrial Filtration (Formerly Mahle) to deliver the PowerGuard™ product line to the North American marketplace. TTI's Dual Phase Microglass media provides world class filtration performance. The Dual Phase technology provides Beta 1000 efficiencies with a built-in pre-filter layer to extend filter life and reduce initial pressure drops.

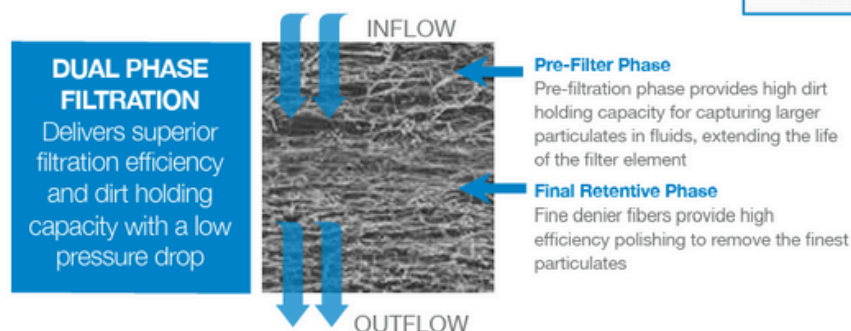

PERFORMANCE

- 150 PSID collapse pressure
- 50 PSID change out recommended
- 250°F (121°C) maximum operating temperature

Dimensions

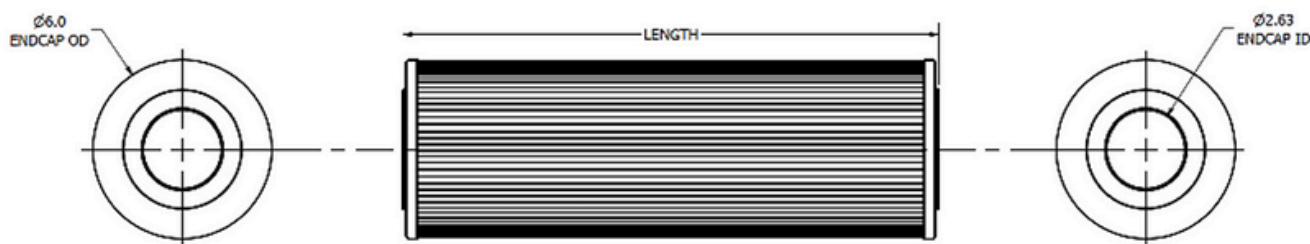

Part Number Builder

TTI PN	-	Length (inches)	-	Micron Rating (µm)		Media Type	Seal Type
TT626		16 = 16.0		1	74*	(Omit) = Dual Phase Microglass <i>Standard option β1000, available in 1, 3, 6, 10, 25µm</i>	B = Buna
		18 = 18.0		3	149*	WA = Water Absorptive <i>Available in 3, 6, 10, 25µm</i>	V = Viton
		34 = 34.0		6		SD = Static Dissipative <i>Viton seals only, available in 1, 3, 6, 10, 25µm</i>	
		36 = 36.0		10		*W = Stainless Steel Wire Mesh <i>Only available in nominally rated 25, 74, 149µm</i>	
				25			

TTHH-107 Housing

TTI's PowerGuard™ high capacity housing line offers a standard 304 Stainless Steel construction that is available in both an 18" and 36" lengths. With features such as a hinge block located on the lid, and 2 ports on both the inlet and outlet of the housing to accommodate differential and sampling gauges.

Specifications

- 150 PSI working pressure
- 304 Stainless Steel
- Hinged lid for safe, ergonomic filter changeouts



Connection Types

2" FNPT



2" Flange



3" Flange



TT107 Series

TTI's PowerGuard™ Filter line is produced in the USA using USA and German materials. TTI has leveraged 58 years of filter manufacturing expertise of FG Industrial Filtration (Formerly Mahle) to deliver the PowerGuard™ product line to the North American marketplace. TTI's Dual Phase Microglass media provides world class filtration performance. The Dual Phase technology provides Beta 1000 efficiencies with a built-in pre-filter layer to extend filter life and reduce initial pressure drops.



DUAL PHASE FILTRATION

Delivers superior filtration efficiency and dirt holding capacity with a low pressure drop

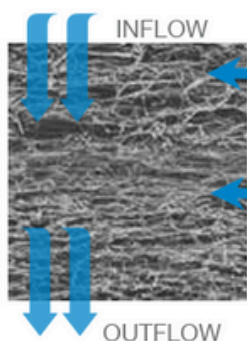

Pre-Filter Phase

Pre-filtration phase provides high dirt holding capacity for capturing larger particulates in fluids, extending the life of the filter element

Final Retentive Phase

Fine denier fibers provide high efficiency polishing to remove the finest particulates

PERFORMANCE

- Collapse pressure dependent on housing
- 50 PSID integral bypass
- 50 PSID recommended change out
- 250°F (121°C) maximum operating temperature

Dimensions

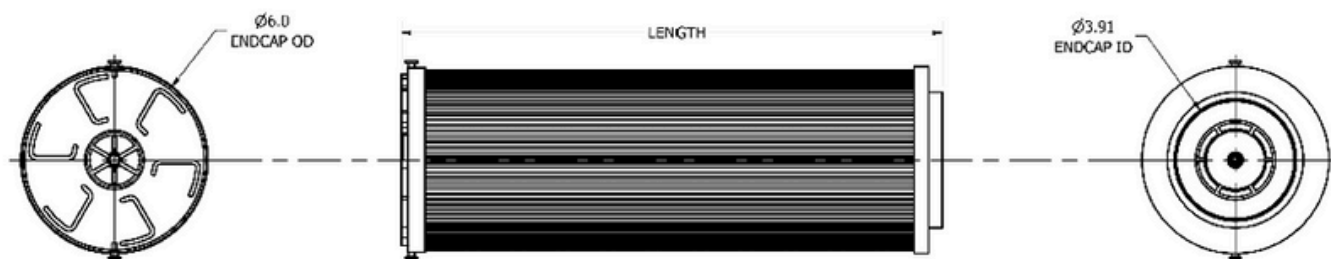

Part Number Builder

TTI PN	-	Length (inches)	-	Micron Rating (µm)		Media Type	Seal Type
TT107		10 = 10.07		1	74*	(Omit) = Dual Phase Microglass <i>Standard option β1000, available in 1, 3, 6, 10, 25µm</i>	B = Buna
		16 = 14.64		3	149*	SD = Static Dissipative <i>Viton seals only, available in 1, 3, 6, 10, 25µm</i>	V = Viton
		18 = 17.30		6		WA = Water Absorptive <i>Available in 3, 6, 10, 25µm</i>	
		36 = 35.60		10		*W = Stainless Steel Wire Mesh <i>Only available in nominally rated 25, 74, 149µm</i>	
				25			

TTHH-207 Housing

TTI's PowerGuard™ high capacity housing line offers a standard 304 Stainless Steel construction that is available in both an 18" and 36" lengths. With features such as a hinge block located on the lid, and 2 ports on both the inlet and outlet of the housing to accommodate differential and sampling gauges.

Specifications

- 150 PSI working pressure
- 304 Stainless Steel
- Hinged lid for safe, ergonomic filter changeouts



Connection Type

2" FNPT



2" Flange



3" Flange



PowerGuard Filter Elements

TT207 Series

PERFORMANCE

- 50 PSID integral bypass
- 250°F (121°C) maximum operating temperature
- Collapse pressure dependent on housing

TTI's PowerGuard™ Filter line utilizes proprietary Dual Phase Microglass Media to provide world class filtration performance and longer service life for your equipment. Our built-in pre-filter layer ensures Beta 1000 efficiencies, reduces initial pressure drops, and provides superior dirt-holding capacity compared to our competitors.

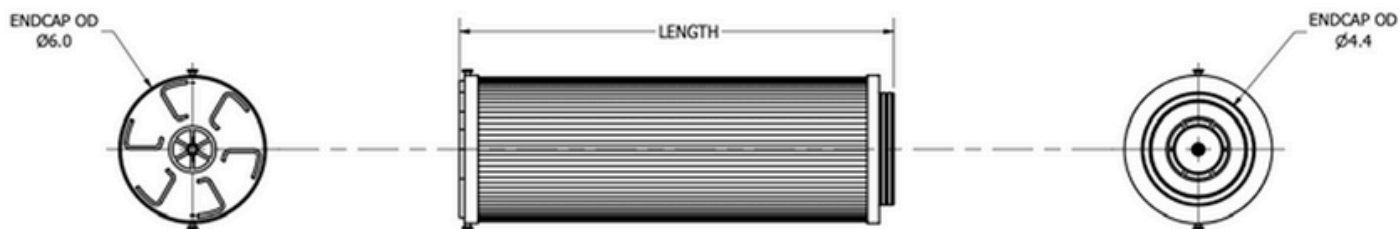
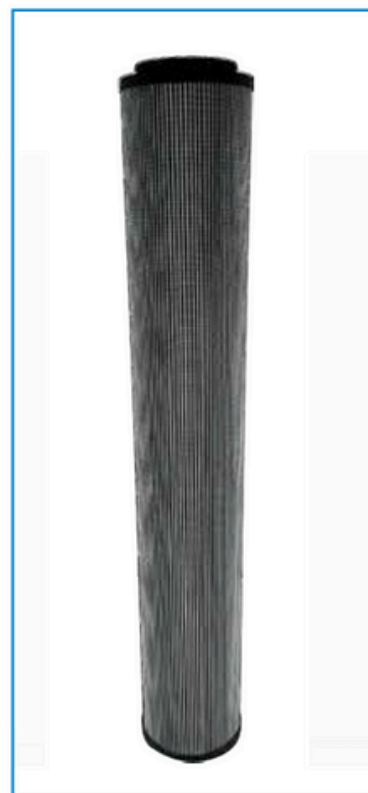

TTI PN	-	Length (inches)	-	Micron Rating (µm)		Media Type	Seal Type
TT207		18 = 17.30		1	74*	(Omit) = Dual Phase Microglass <i>Standard option β1000, available in 1, 3, 6, 10, 25µm</i>	B = Buna
		36 = 35.60		3	149*	SD = Static Dissipative <i>Viton seals only, available in 1, 3, 6, 10, 25µm</i>	V = Viton
				6		WA = Water Absorptive <i>Available in 3, 6, 10, 25µm</i>	
				10		*W = Stainless Steel Wire Mesh <i>Only available in nominally rated 25, 74, 149µm</i>	
				25			

TTHH-HC-4MS Housing

TTI's PowerGuard High Capacity Housing Line is the industry-leading choice for protecting your filter elements and extending the optimum performance of your machines.

Each TTHH-HC-4MS housing is constructed from 304 Stainless Steel and houses up to four industry-leading TT207 filter elements. Premium features include a solid mounting base, 290 PSI operating pressure, user-friendly closure flange, multi-directional gauge brackets, and sample/DP gauge ports.

Key Features

Maintenance friendly davit arm lid assembly with swing bolt closure flange.

Differential Pressure Gauge mounting bracket included standard. (consult TTI sales team to add DP Gage).

Bypass valve standard in each filter element guarantees consistent performance and optimal fluid cleanliness with the safety on an integral relief.

Square base: 20" with bolt holes to allow 5/8" [M16] anchor bolts for skid installation or mounting on pedestal (Consult TTI Sales Team to discuss custom pedestal base add-on).

2 - 1/4" NPT DP gage ports standard
2 - 1/4" NPT Sampling ports standard
1" NPT Low Point Dirty Drain port for fluid evacuation
1/2" NPT Low Point Clean Drain port for fluid evacuation

Top Applications

- Pulp and Paper Mills
- Steel Mills
- Power Generation
- Bulk Fuel Particulate Filtration
- Flushing applications
- Large Reservoir Kidney Loop Filtration (Inline/Offline)



Performance Specifications

- 290 PSI working pressure - 2Mpa
- 750 GPM Flow Rate
- 304 Stainless Steel
- Hinged Lid for Ergonomic Filter Changeouts
- 32°-250° F (0°-120° C) Operating Temp Range
- Buna Seal Type Standard, FKM and EPDM available upon request

Fluid Compatibility

- Diesel Fuel and Fuel Oils
- Biodiesel up to B20
- Mineral Oils
- Synthetic Oils
- Skydrol™, Hyjet™, Fyrquel™, EcoSafe®
- AW Lubricants
- Water Glycol

TTCH-538 Diesel Fuel Coalescer Housing

TTI's PowerGuard Diesel Fuel Coalescer Housing Line is the industry-leading choice for maximizing the efficiency and extending the life of your fuel delivery system.

Designed to remove water and particulate contaminants from diesel fuel with an impressive 99% single-pass efficiency, TTI fuel coalescers significantly reduces wear and tear on your system, helping to extend service intervals and enhance overall operational reliability.

Key Features

Diesel Fuel polishing and Coalescing - Flow rates up to 30 GPM single vessel

Universal bracket mount supports motor frame size 56C/143T/145T- provides location for customizable bracket installation by customer as well

Rigid base for skid mounting pattern is 7.75-inch square centerline with 5/8 inch diameter holes [M16] anchor bolts for skid installation or mounting on pedestal (Consult TTI Sales Team to discuss custom pedestal base add-on)

Fluid Compatibility

- Diesel Fuel and Fuel Oils
- Biodiesel up to B20

Top Applications

- Common Rail Diesel Fuel Polishing
- Drill Rig Fuel Polishing
- Mining Applications
- Merchant Marine Applications
- Bulk fuel storage/Bulk Fuel Delivery
- Large agriculture fuel conditioning
- Earthwork/Excavation
- Single pass or Multi-pass polishing
- Backup Power Generation



Performance Specifications

- 150 PSI working pressure
- Corrosion Resistant 304 Stainless Steel
- Hinged Lid for Ergonomic Filter Changeouts
- 30°-180° F (0°-82° C) Operating Temp Range
- Viton Seal Type Standard
- Integral post design ensures positive seal
- Swing bolt closure flange with integral tilt lid
- 2" Raised Face Flange inlet and outlet
- 1" Female NPT alternate inlet outlet ports
- 2 1/4" FNPT DP gage ports standard
- 2 1/4" FNPT Sampling ports standard
- 1/2" FNPT Low Point Water Leg Drain port
- 1/2" FNPT Low Point Clean Drain port
- 2 1/2" NPT ports for sight glass 10" centerline
- 2 1/2" BSPP (G thread) ports for instrumentation
- 1/4" FNPT vent port in lid